

SPRING 2024

LAKE LIMERICK COUNTRY CLUB NEWSLETTER



790 E. ST. ANDREWS DR., SHELTON, WA 98584

OFFICE: 360.426.3581 OR MAIL@LAKELIMERICK.COM

IN THIS ISSUE:

- **GREEN BELTS & TRAILS**
- **GREENS**
- **ARCHITECTURE**
- **INN**
- **LAKE DAM**

LLCC ANNUAL MEMBERSHIP MEETING/SPECIAL BOD MEETING FOR ELECTION OF OFFICERS

SATURDAY, APRIL 20TH @ 2:00PM VIA HYBRID

(LLCC GREAT HALL & ZOOM)

MEETING ID: 843 6110 8400

PASSCODE: 334060

President's Message

Dear Lake Limerick Community,

The notion that meaningful transformations are often messy, but worthwhile was not something I initially anticipated when I first joined the LLCC HOA Board of Directors. Initially, I was focused on understanding the workings of our board and organization, without considering leadership positions. However, in July of 2023, I was asked to step into the position of Board President, a responsibility I have endeavored to fulfill to the best of my ability for the betterment of our community.

Drawing from my experiences as an Executive Director and board member in other organizations, it became clear that we lacked a comprehensive understanding of our organization from a holistic perspective. This led to engaging with Human Resources and Board Governance Consultants. Their feedback has been instrumental in guiding us through the necessary changes to address the challenges and growing changes we are facing.

I am proud of how our Board members and Staff have risen to the occasion, taking on new tasks and demonstrating their capabilities in the face of unforeseen challenges. The Board's support in initiating much-needed training will equip current and future boards with the skills necessary for effective governance and leadership of our growing and diverse community.

Moving forward, we are finally making progress on developing a 5-year strategic plan, a process that has experienced delays since 2017. This plan will enable us to better manage our assets, plan for projects outlined in our Reserve Study, and align with the vision set forth by our General Manager.

Reflecting on the past ten months, I acknowledge there has been a great deal of growth, but it has been undeniably worthwhile. I am optimistic about our shared future and invite you to join us in our ongoing transformation by volunteering with a committee. Your involvement, whether through attending meetings or assisting with specific projects, is invaluable in shaping our community.

Tamra 'Tam' Ingwaldson

PRESIDENT

LLCC BOARD OF DIRECTORS

LAKE LIMERICK COUNTRY CLUB NEWSLETTER

MEET THE BOARD CANDIDATES

- GREG HEARRON
- BRIAN SMITH
- JOAN KOROL
- TAMY FLETCHER
- ESTHER JOHANNESSEN

LLCC ANNUAL MEMBERSHIP MEETING / SPECIAL BOD MEETING FOR ELECTION OF OFFICERS

SATURDAY, APRIL 20TH @ 2:00PM VIA HYBRID

(LLCC GREAT HALL & ZOOM)

MEETING ID: **843 61 10 8400**

PASSCODE: **334060**

MEET OUR BOARD CANDIDATE'S



GREG HEARRON
BOARD



BRIAN SMITH
BOARD

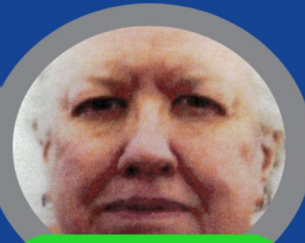

JOAN KOROL
BOARD



TAMY FLETCHER
BOARD



ESTHER JOHANNESSEN
BOARD

WWW.LAKELIMERICK.COM



BALLOT BOX

PLEASE NOTE:

YOUR BALLOT CANNOT BE COUNTED IF IT IS NOT IN THE BLUE ENVELOPE WITH YOUR DIVISION / LOT NUMBER AND YOUR SIGNATURE.

BALLOTS DUE BY SATURDAY, APRIL 19TH BY 5:00 PM ✓

LAKE LIMERICK COUNTRY CLUB NEWSLETTER

MEET THE WATER CANDIDATES

- KELLY EVANS
- KEITH MATHCHES
- TAMY FLETCHER

LLCC ANNUAL MEMBERSHIP MEETING/SPECIAL BOD MEETING FOR ELECTION OF OFFICERS

SATURDAY, APRIL 20TH @ 2:00PM VIA HYBRID

(LLCC GREAT HALL & ZOOM)

MEETING ID: **843 6110 8400**

PASSCODE: **334060**

A blue graphic with the text "Meet THE CANDIDATES" in white and green. It features three circular portraits of candidates: Kelly Evans, Keith Matches, and Tamy Fletcher. Each name is written in a white pill-shaped box next to their portrait, with their role "Water Committee" written below.

KELLY EVANS

Water Committee

KEITH MATCHES

Water Committee

TAMY FLETCHER

Water Committee

WWW.LAKELIMERICK.COM



BALLOT BOX

PLEASE NOTE:

YOUR BALLOT CANNOT BE COUNTED IF IT IS NOT IN THE BLUE ENVELOPE WITH YOUR DIVISION / LOT NUMBER AND YOUR SIGNATURE.

BALLOTS DUE BY SATURDAY, APRIL 19TH BY 5:00 PM ✓

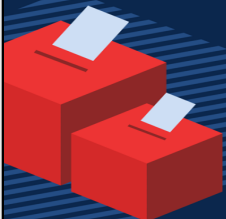

LAKE LIMERICK COUNTRY CLUB NEWSLETTER

GREENBELT AND TRAILS



What does the Greenbelt Committee do? This is a good Question. Lake Limerick is surrounded by a greenbelt that varies in width but is mostly 20 feet wide. Internally, there are many individual greenbelt areas that run between properties and there are other areas that are not owned by individuals but owned by all community members together. These greenbelt areas are what this committee tries to manage.

The committee is looking at possible trails in these areas. Maps were made of low traffic roads and existing trails the community members can use for several walks around the community. Looking at creating a trail from Dartmore to the unused back part of Olde Lyme Park. The committee has just started looking at what it might take to get Mason County to put in a sidewalk along St. Andrews. say from the Fire Station to the Inn.

Because a member cut down trees without permission in a greenbelt area along Mason Lake Road, this committee worked to get 20, 7-foot trees planted to replace those cut down. The committee has also worked with members to improve the appearance of the Ballentrae entrance.

There are 4 adjacent properties that are owned by Lake Limerick that the committee has been looking at for a variety of possible uses, such as a dog off leash area, a community garden, or possibly a larger maintenance area.

The 4th of July fire last year inspired the committee to look at our greenbelts that could possibly be used as secondary exits from our many one way In and one way out neighborhoods if the main roads were for some reason blocked. This has led to this committee taking the lead in working with Mason Emergency Management in setting up an emergency management and communication plan for Lake Limerick.

The committee meets the first Thursday of each month at 6:00 PM in the Crowsnest in the Inn.

DEAN DYSON

GREENBELTS AND TRAILS CHAIRMAN

SPRING 2024

LAKE LIMERICK COUNTRY CLUB NEWSLETTER

GREENS COMMITTEE



Happy Spring! The Easter Bunny is gone and it's time to dust off those clubs from winter and enjoy some beautiful weather on the golf course.

Men's and Women's leagues have started and are always looking for new members. People joining leagues participate when their schedules are free. You could play 2 or 3 times a week or 2 or 3 times all summer-Your always welcome.

Lake Limerick members get a discount on their golf and when you bring a guest, they also get a discount rate compared to our public rate. If you are new to golf and want to learn the game for yourself or your children, the pro shop staff offer lessons. We also completed a beautiful practice area that is now open to work on your game.

This year we partnered with Wake-Up Espresso to put on a tournament series throughout the year taking place the third Saturday of every month. Lake Limerick members Scott and Beca Eichhorn are the owners of Wake-Up Espresso and Scott came up with the series idea to attract more public play on our course.

April is also the Masters partnership Tournament and are all welcome to participate.

For those non golfers that enjoy walking in our community, we are one of the few golf courses that welcome walkers on our golf cart paths. The busiest times on the course are generally in the mornings but whenever you walk the course just be careful of errant hit golf balls.

The pro Shop is open seven days a week and we love answering questions and want you to try golf at our course. Lake Limerick was rated number 19 in the country from Golf Now for Short Courses in the United States. Stop by the pro Shop when your schedule permits and let us help you with your golf needs.

We have had a good winter. We have rebuilt three tee boxes. Worked on drainage problems. We fund raised to cover cost. We have a great Ambassador program that keeps costs down.

Javier Martinez, Greens Superintendent and his crew has the golf course ready for the season,

We re voted as one of the top 9-hole golf courses in the country. Mark Hendricks and his crew are ready for the season.

The Café' has new flooring and paint. It is a good update. They are serving great food.

We invite you to come and enjoy your facilities. If you have any questions, please call the pro-shop.

See you on the golf course and at the café.





VERN DUGGAN

GREENS CHAIRMAN

LAKE LIMERICK COUNTRY CLUB NEWSLETTER

ARCHITECTURE COMMITTEE

The sun is shining a little brighter, the birds are chirping a touch louder, our favorite season is upon us - ****SPRING! **** It's time to shake off the winter blues and spruce up our spaces! If you're planning any cleanups, repairs, or exciting projects, kudos! Just a friendly reminder that any structural changes, including (but not only) fences, decks and sheds, require a nod from the Architecture Committee. We're here to ensure that our community blossoms with beauty and compliance. When in doubt, don't hesitate to reach out, contact arch@lakelimerick.net or come to a meeting (2nd Friday of the month in the Crows Nest @ 3:30 PM). We're here to answer questions, provide guidance, and ensure that your projects align seamlessly with our community guidelines. We're your partners in making Lake Limerick the best it can be.

	Property Lines	Identify lot lines and lot size. This will be your basis for your setbacks.
	Setbacks	If you are building or adding something to your property, clearly marking the setbacks is critical. Per the association guidelines, no building shall be erected 30' from street lot line, 5' from sidelines, 50' from waterfront or golf course. Check out the guidelines for more restrictions.
	Clearing Trees	If your property does not have a house on it, you must notify and get approval from the Architecture Committee prior to clearing trees. If you're property does have a house, you do not require a permit, however, it is good practice to notify the committee for awareness.
	Fence	Adding a fence? Show us where on the property and don't forget those setbacks. There are restrictions from the street and water or golf course.
STREET / LAKE / GOLF COURSE / ETC.	Labels	Label key landmarks. This tells us what structures are and where the front or back of the house is.

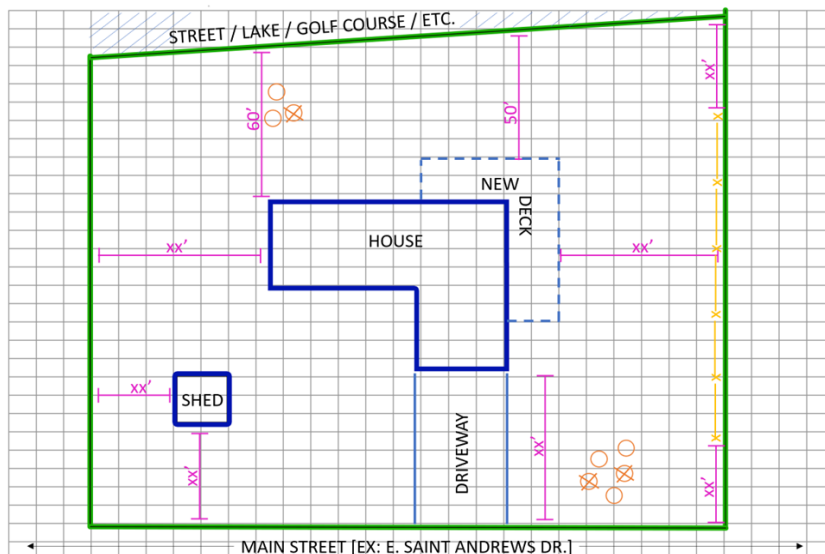

LAKE LIMERICK COUNTRY CLUB NEWSLETTER

THE INN COMMITTEE



The Inn Committee continues to bring activities and events to the Lake Limerick Community year around. Our dedicated volunteers (the best), work very hard to bring a variety of events to our community such as Trivia and Bingo monthly, Shenanigans in the Bar for St. Patrick's Day, Easter Egg hunt, Lake Limerick Daze which includes music, food, games, and the infamous Parade. Music events continue throughout the summer with the seasonal End of the Summer Bash which is a HOA gathering featuring Free Hot Dogs and Root Beer Floats for our members. During the Christmas Holidays we gather with Santa of course for our tree lighting, cookies, singing holiday songs for fun for young and old. Why do we give our time and energy to these events? We believe that it is important to be a community and to meet our neighbors and maybe make new friends. We also recognize we have a variety of ages and incomes in the community which should not be a barrier. For the above events, there is no cost to you and your family to attend and enjoy the activities provided. If you wish to purchase additional food or beverage that is completely your choice.

Because of volunteer labor, sponsored music, and talented community members willing to perform we continue to have a positive effect on our food and beverage budget dramatically increasing revenue on event nights and still providing fun for all.

We do have charged events and that is because it seems unfair to have the community "pick up the tab" for wine tasting or New Year's Eve Party this type of event is designed to have a positive effect on the Food and Beverage budget and achieves that.

In summary, how can you help?

- Join us the second Saturday of the month in the restaurant at 9:30am
- If you are not much into meetings, we started a group "Friends of the Inn Committee" if you want to help from time to time without any obligation, email me with your info and we can let you know the upcoming events and how you may help if you choose. inn@lakelimerick.net
- We have had over the last several years a change in the demographics of our community and many are looking to meet new people. Working with the Inn Committee provides that opportunity.
- We need new ideas on activities, things change, and we need to as well.

Thank you from the entire Inn Committee,

PAUL WAGNER

INN COMMITTEE CHAIRMAN

LAKE LIMERICK COUNTRY CLUB NEWSLETTER

LAKE DAM COMMITTEE



Spring has Sprung – Yay! So it’s a good time to get ready for boating season and prepare for Spring & Summer activities. Now is a good time to familiarize yourself with our “Park Rules and Safety Guidelines” as well as the “Lake Rules and Safety Guidelines”. If you are considering repairing or replacing your dock or installing a boat lift, please refer to the “Dock and Float Guidelines” to assist with the permitting requirements. We are “kicking-off” Spring with the LLCC Fishing Derby on April 27th and your Derby Team has been working feverishly to set up another fun event.

The Lake/Dam (LD) Committee is responsible for supporting our lakes, dams, and parks, recommending usage rules, monitoring maintenance, and planning and supporting long term improvements. Over the last year we completed several priority projects and supported on-going initiatives including:

1. Updating our Park Restrooms (new roofs, doors, locks, paint etc.); plus replacing old wood picnic tables with new metal tables at several of our parks.
2. Updated several of our rules, guides, operations, and process documents.
3. Demonstrating the operability of our emergency water release valve on the Lake Limerick Dam.
4. Recruited summer Park Hosts.
5. Conducting periodic park walk-throughs to address safety and maintenance needs.
6. Continuing Water Quality Measurements in both Lakes for total Phosphorus and Nitrogen concentrations to support actions for ensuring long-term lake health and proper weed management.
7. Continuing automated data capture of Lake Limerick levels and temperatures for future lake management needs.

A Big Thank You to LLCC Facilities Maintenance Team, Gerardo and Elias, for great year around park maintenance and supporting our LD Work Order requests. Lastly, we continue to experience vandalism of our parks and amenities so please keep an eye out and report suspicious activity. Thank You and have an enjoyable Spring/Summer.

TEDDY LOVGREN

LAKE DAM CHAIRMAN

LAKE LIMERICK COUNTRY CLUB NEWSLETTER

LAKE DAM COMMITTEE



FISHING DERBY/FISH PLANT - DENNIS MURETTA

Lake Limerick will be conducting its annual fishing derby on April 27th. As in past years, the derby is planned as a day of outdoor fun and activities for members, their family and friends. Fishing will commence at 6AM on Saturday morning and promptly conclude at 1PM, the cutoff for fish weigh-in. This year, cash prizes for biggest fish in both children's and adult categories are being increased to: first place @\$125, second place @\$75, third place @\$50, fourth place @\$30 and fifth place @\$20. As in past years, we will feature a breakfast buffet, a hot dog lunch and drink specials throughout the day at our derby headquarters, the LLCC Inn. We will also distribute thank you gifts to each child with a derby ticket along with a coupon for an ice cream treat, consistent with our emphasis on encouraging children to engage in fishing. These gifts are enabled by generous donations from a few of our members. After the derby awards ceremony, we will have a second chance drawing for (non- winning) adults with derby tickets followed by a raffle drawing for special items donated by members and local businesses (\$1.00 per ticket). Lastly, a silent auction of donated items will be held during derby hours so you can competitively bid on your favorite item. The proceeds from ticket sales, the raffle and the silent auction typically offset derby costs. On a different note, your derby team requests you consider donating to our derby in support of the raffle and silent auction. Donations can be anything you think would be of value to members such as handcrafted items, fishing tackle, tools, art or cash (please no damaged or soiled items). If in question, call and we can discuss what you were thinking of donating and provide advice (Leanne 253-691-8644 or Dennis 425-432-3364). Donations can be dropped off at the office (Rhonda) or you can call one of the above for pick up.

MARK YOUR CALENDARS AND THANKS FOR YOUR SUPPORT IN ADVANCE



**2024 LAKE LIMERICK
FISHING DERBY**

LAKE LIMERICK COUNTRY CLUB NEWSLETTER

LAKE DAM COMMITTEE



PARK MAINTENANCE/IMPROVEMENTS – DENNIS, MAUREEN & STEVE GLENN

The Lake Dam committee started a multi-year program in 2023 to update and improve our parks so that member visits might be more enjoyable. This effort was initiated in response to specific member suggestions submitted in our 2022 Parks survey. The initial focus of this effort has been on upgrading all park restrooms, which are admittedly in need of a little attention. To date we have accomplished the following: 1) all restrooms and outbuildings have been reroofed 2) new steel doors with electronic cypher locks have been installed on all restrooms and 3) Banbury restrooms have been upgraded with area and water heaters to allow year around usage to support walker, joggers and occasional visitors. The steel doors and electronic locks are intended to control excessive after-hours vandalism we experience. The locks can be preset to automatically open and close at specific times, meaning they are locked between dusk and dawn. As the next steps, all restrooms will be painted and floors sealed once the weather warms. We also intend to upgrade one of the Log Toy restrooms to ADA compliance later in the year.

We would appreciate any feedback you have on our progress to date. Vandalism continues to be a major issue for us. Recently, park benches were broken in one park, swing mats continually get thrown into the woods and lake. Tagging of signs and play toys seems to be the latest sport and boulders were recently dislodged into the access road at another park. If you see or hear of this activity, please report it to the office. The parks belong to all members and our facilities crew spends entirely too much time correcting these idiotic acts.

2024 PARK HOSTS - DAVE KOHLER

LLCC PARK HOSTS

LLCC had four of our lakeside parks staffed with Park Hosts last summer, and we'll have all four parks covered again this year. We really appreciated the hosts' support in providing some much-needed guidance to members and guests. Just a reminder that our hosts are here from mid-May into September and are on duty from mid-day to dusk on Friday, Saturday, and Sunday. They are here to help ensure park visitors follow the rules. Remember, Park Hosts will be asking for membership identification or guest passes when individuals are using our parks.

LAKE LIMERICK COUNTRY CLUB NEWSLETTER

LAKE DAM COMMITTEE

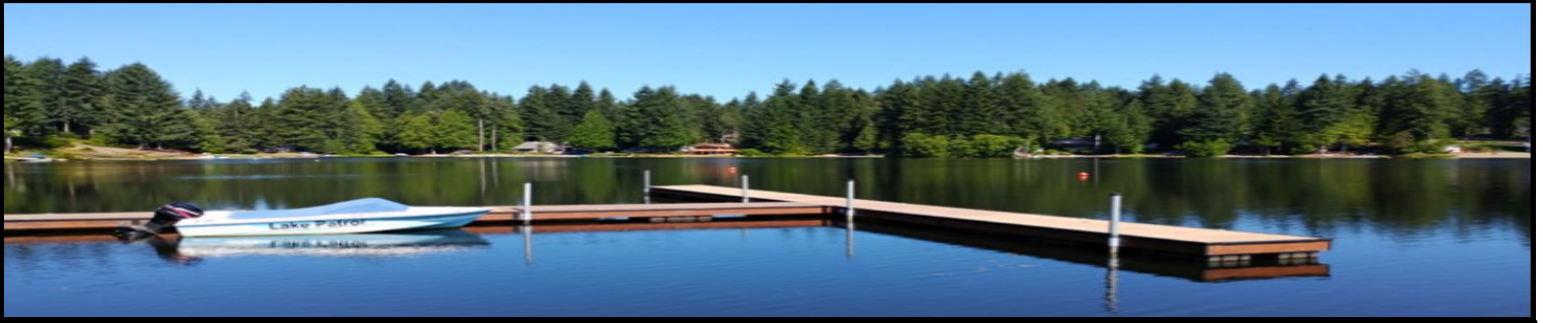

GUEST PASSES

Lake Limerick Country Club is enforcing the existing policy that requires proof of membership, in order to use the Club's parks. We have taken this step to help control vandalism and ensure the availability of our facilities for all our members and their guests.

Guest passes are reissued periodically. If you need an LLCC Member ID card or an LLCC Guest Pass, please make arrangements to pick one up in the office. You will be asked to leave our parks if appropriate ID is not available.

PUBLIC BOAT LAUNCH

The Club has three private, members' only, boat launches on Lake Limerick. There is also one Wash. Dept. of Fish & Wildlife public launch off of St Andrews Drive. Remember, in order to use the public launch, a Washington State Vehicle Use Permit (VUP) or a Discover Pass is required. VUPs are free with an annual Combination, Saltwater, or Freshwater fishing license, or may be purchased separately.

2024 LAKE PATROL/BOAT REGISTRATION/ WATERSPORT SAFETY— LOU JACKSON

Now is the time to plan for the 2024 Boating season. Make sure your boat is ready for this up-coming season. Get your fishing license, put your Lot & Division number on your boat and all your water toys. Information about Lake Rules and Safety Guidelines, Dock and Float Guidelines, Vessel Registration Procedures and Forms are available in the LLCC Office or on the LLCC website.

LAKE PATROL

Applicants are needed for Lake Patrol (April – October). To learn more please review the Lake Patrol Guidelines available on the LLCC website or attend one of the monthly Lake Dam meetings held the 1st Saturday of each month. In summary the requirements for being a Lake Patrol volunteer are:

- Possess a Washington Boater Education Card.
- Demonstrate proficiency in boating skills to the satisfaction of the Lake Dam Committee.
- Be of a friendly nature.
- As a Lake Patrol Volunteer, one has to have a basic knowledge of the LLCC lake rules and safety guidelines and vessel registration requirements. If you are interested in joining the Lake Patrol please attend a Lake Dam monthly meeting or leave your contact information at the office.

To all our volunteers THANK YOU. Be SAFE, Be FRIENDLY - Lou

LAKE LIMERICK COUNTRY CLUB NEWSLETTER

LAKE DAM COMMITTEE

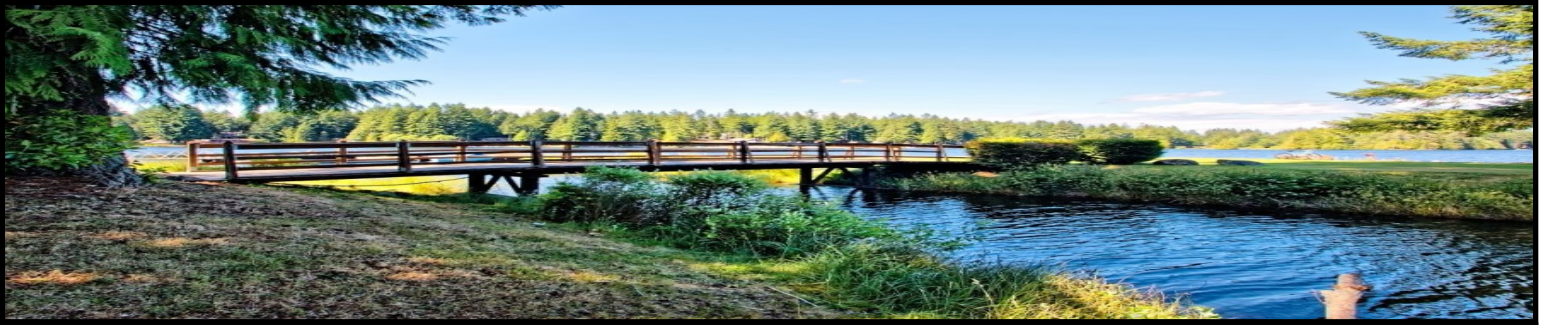

REGISTER YOUR BOAT - DON'T FORGET!

Any vessel over 16 feet or powered by a motor of 10 HP or greater requires registration by the State and LLCC. Your boat will need to be registered in the office before putting it on the lake.

You will need to be a member in good standing and have the current Washington State Registration with you when you register in the office. In addition to displaying a current Washington State registration tag (or state of primary registration if used in Washington for a limited time) and WN number on your vessel, you need to display a Lake Limerick registration decal on the right side (preferably at the side windshield). Remember, your boat must also have your division and lot number prominently displayed on the rear sides, both port and starboard. Thanks in advance for your cooperation.

BOATER EDUCATION CARD REQUIRED - IT'S A STATE LAW!

In Washington State, persons under 12 years of age may not operate a power-driven vessel with an engine that is 15 horsepower or more. You are required by Washington State law to carry a Boater Education Card if you:

- Operate a vessel with a 15-horsepower (or greater) motor.
- Were born after Jan. 1, 1955.
- Are 12 years of age or older.

Vessel operators who are required to have a Boater Education Card must carry the card on board the vessel and have it available for inspection by an enforcement officer. Not carrying your Boater Education Card when one is required can result in a fine. You can find out about the Boater Education Card and course online at:

<https://www.boat-ed.com/washington/>

IMPORTANT WATERSPORT SAFETY TIPS

The key to safety on a small and busy lake is to be able to predict what other people are going to do. That is why we have the ski lanes, so that everyone knows what to expect, that is, a vessel traveling at a consistent speed in a straight line. Any time someone deviates from a clear pattern of behavior, accidents are possible. Follow the lake rules and please keep in mind the following:

LAKE LIMERICK COUNTRY CLUB NEWSLETTER

LAKE DAM COMMITTEE



- **The integrity of the ski lanes must be maintained.** Vessels with something or someone in tow have the right of way over all other watercraft (except sail boats). All vessels, including fisherman, must yield the right of way to vessels towing someone and should avoid the ski lanes during skiing hours. Let's try to get along on a multi-use lake.
- **When a skier or tuber falls,** the towing vessel must quickly come off of its plane and turn towards the buoy line (to the right) to retrieve the person that just fell. **Do not** turn left into the lake under full throttle making a sweeping turn. This eats up real estate and blocks the path of any boat that is behind you which needs to pass you on the left.
- **Stay a safe and reasonable distance** from other skiers, vessels, swimmers, anglers and danger areas. The towrope should be no more than 75 feet long. Keep the skier at least double that distance away from all potential hazards.
- **Tubing must not exceed 20 mph.** Stunting, such as doing donuts or making swerving "S" maneuvers, increases wake size, is unpredictable and is **absolutely not allowed.**
- **No starting or dropping of skiers or tubers inside the buoy line,** this is extremely dangerous. A person being towed shall never attempt to cross the buoy line when being dropped. It is difficult to see around the towing vessel and this is the most likely cause of a collision with someone else.
- **Never exceed 6-mph shore side of the buoy line.** There are just too many chances for collisions with people and property, shore-side of the buoy line.
- **Property owners shall not attempt to move buoys** that are placed to facilitate clear traffic patterns. Moving a buoy can result in a jagged buoy line, which in turn causes swerving and increased wave action.

PROCESS DOCUMENT UPDATES [DENNIS MURETTA]

Over the course of the fall/winter, the Lake Dam committee completed updates to several important LLCC process documents. The documents and update content include:

1. **Lake Patrol Guidelines;** The Lake Patrol has an important function in supporting safe member utilization of Lake Limerick. The current Lake Patrol guidelines allowed for video recording of incidents encountered by LP members while on patrol. The guidelines are not, however, specific on the control, dissemination, utilization and storage/destruction of recordings. It was also silent on the subject of audio recordings. An update was developed and approved by the BOD which addressed these shortcomings. Audio recordings are strictly forbidden without the consent of all parties involved. Video recordings must be managed in accordance with a strict set of protocols.
2. **Vessel Registration Procedures and Forms:** LLCC vessel registration provides a means for LLCC to ensure Lake Limerick utilization is restricted to members only and that oversized vessels which could damage shorelines are not allowed on our lake. Existing regulations were confusing and captured in several different documents. A consolidated process document was developed which clearly defined office, Lake Dam and BOD responsibilities for registering vessels for use on Lake Limerick.
3. **Volunteer Park Host Application and Duties:** During summer months, Lake Limerick solicits park hosts who, using their RV's, are allowed to camp in our parks. In exchange, the park hosts provide a presence in the park, offer members park information and usage rules and also represent an element of security. Several provisions in the Park Host document, such as telecommunication allowances, were outdated and required updating.

LAKE LIMERICK COUNTRY CLUB NEWSLETTER

LAKE DAM COMMITTEE



LAKE HEALTH (WEED TREATMENT, STUDIES, SURVEYS, ETC.) - BRIAN SMITH

At the end of 2022, the LLCC Lake Dam Committee set up a Long-Term Lakes Health Team (LTLHT) to develop an action framework to protect and enhance water quality in Lakes Limerick and Leprechaun; to improve recreational opportunities; and to prevent deterioration of the Lakes' habitat. Such a framework would also provide a more coherent explanation of how the various lake project proposals, particularly those proposed for funding in the current budget, and those in the HOA Reserve Study, work together to preserve and maintain LLCC's aquatic assets.

The Team has focused on developing Goals, Objectives and Actions related to the physical conditions of the lakes, working in concert with the HOA's limnology consultants, Lake Advocates, who have helped the HOA manage our lakes for several decades. The LTLHT is not addressing use issues like boating or other recreational uses nor are we developing a comprehensive Lake Management Plan at this time.

The LTLHT has established two overarching goals: protecting and improving water quality in Lakes Limerick and Leprechaun while discouraging harmful plant and algae growth; and establishing appropriate water levels within both lakes balancing such competing factors as recreational and irrigation needs, maintaining flows in the fish ladder and downstream in Cranberry Creek to protect salmon habitat, beach maintenance, member property uses and riparian tree health.

The team believes the HOA needs to base lake decisions on facts, not anecdotes and lore. To that end it has monitored and worked with the efforts of Lake Advocates as several studies have been completed over the last year. These include a bathymetric survey of the lakes to provide historic and baseline information related to water depth and the need for future dredging projects; a walk of Cranberry Creek between Cranberry Lake and Lake Limerick, which resulted in information indicating that a proposed sedimentation pond along the creek would not reduce the inflow of sediment into Lake Limerick and could therefore be removed from future funding plans; the recently completed Plant Survey Report and Management Actions; and collection and interpretation of information concerning water temperature and depth, and chemical makeup collected from data loggers.

The team has also worked on several Project Approval Requests for projects such as dredging and vegetation removal in the Bird Sanctuary, a high priority for the Lake dam Committee. The team has also participated in discussions with the HOA and Squaxin Tribe concerning their grant proposal to the Department of Ecology for a study on how to best maintain water flow in Cranberry Creek to protect habitat for salmon smolt.

LAKE LIMERICK COUNTRY CLUB NEWSLETTER

LAKE DAM COMMITTEE



LAKE LEVEL MANAGEMENT (DAM MAINTENANCE, INN ISLAND EROSION/BRIDGE REPAIR) - JOEL GRAY

MAJOR LAKE/DAM MAINTENANCE TASKS

Dams - The Lake Limerick community includes two individual dam structures which create, as impoundments, Lake Limerick and Lake Leprechaun. There is also a flood control dam on Cranberry lake at the outflow of Cranberry creek which is designed to temporarily impound Cranberry Lake flood water in the event of a major storm in order minimize damage from downstream flooding and erosion. Our dams were installed under permit from the Washington State Dept. of Ecology and our community is responsible for performing specific dam inspections and maintenance on a yearly basis. Inspection and maintenance requirements are governed by the LLCC Dam Operations and Maintenance Manual and provided to the Washington State Dam Safety Office (DSO). The Lake Dam Committee recently updated the manual to better address lake level management as well as emergency draw down procedures for both dams. The update has been approved by the Board Of Directors and a copy forwarded to the DSO. Yearly planned dam inspection and maintenance tasks are currently proceeding including visual inspections, valve exercising and specific maintenance actions.

Inn Island - Lake Dam is also focusing an increasing amount of attention on long term utility of our Inn Island. This includes:

1. Inn Island Erosion Control – Several years ago, we reinstalled the log boom in front of the Inn Island to reduce erosion resulting from wave action. This log boom has significantly helped with this issue. LLCC is now working with potential contractors to develop and bid on a technical solution to the erosion and improve access to the swim beach area that would be acceptable to Mason County and the Lake Dam Committee on behalf of LLCC membership.
2. Inn Island Bridge Stability – Last year, we hired a local Structural Analysis firm to evaluate our Inn Island bridge for overall integrity and soundness. We received a report which said the bridge structure was sound, but we needed to paint exposed steel components and improve stabilization of the railings. We are planning to complete these two recommendations when the weather permits. We also recently noted some isolated deterioration in areas of the structural beams under the bridge and we are in the process of assessing the extent of this condition. We do not believe bridge integrity is compromised and will have more to report in future newsletters.

LAKE LIMERICK COUNTRY CLUB NEWSLETTER

WATER COMMITTEE



LLCC WATER SYSTEM COMMUNITY UPDATE

ACCOMPLISHMENTS FOR 2023 TO THE PRESENT

- Completed Water System Plan documents and submitted to the Washington State Department of Health for Review
- Looked to the future and included a very modest increase for well and mainline reserves
- Raised basic water allotment to 6000 gallons per month
- Provided water fill facilities and support for fire fighters during McEwan Prairie fire
- Presented a 2023-2024 balanced budget with minimal rate increase and received approval by the BOD and membership
- Met with CMFE leadership and developed next steps for activating some fire hydrants
- Helped to create a plan to work with the U.S. Navy regarding the railroad trestle retrofit resulting in a potential savings to LLCC of over \$220,000.00

ONGOING CHALLENGES

- Managing aging infrastructure and finding/repairing breaks in water distribution lines
- Dealing with inflation at or above 3% - better than last year but still too high
- Recognizing hardships for members with cost-of-living increases in all sectors of society
- Engineering for the future including elevated storage and mainline replacement
- Keeping up with government regulations and safeguards
- Correcting mis-information spread throughout the community via social media

LAKE LIMERICK COUNTRY CLUB NEWSLETTER

WATER COMMITTEE



**LAKE LIMERICK
COUNTRY CLUB**

~
**LIFE IS BETTER
AT LAKE LIMERICK**

Please see questionnaire in June's water bill regarding property water service lines. Your feedback is invaluable in helping us with information regarding your water piping. Please find the attached questionnaire and return it to the HOA Office no later than June 1, 2024.

LLCC WATER SYSTEM COMMUNITY UPDATE

PRESENT ACTIVITIES

- Planning for necessary short-term and long-term system upgrades
- Continuing systematic project monitoring and review
- Improving parts and equipment inventory
- Finding and repairing leaks in a timely manner
- Increasing staff hands-on repairs to reduce the need for outside contractors
- Continuing excellent reduction in Account Receivables
- Completing projects including source meter installation, well analysis and elevated storage studies, and water quality testing stations

THE EXCITING FUTURE

- Modernizing the SCADA well monitoring software
- Continuing long-range planning for infrastructure improvements including Well #2 filtration
- Anticipating potential changes in state DOH requirements including filtration and chlorination
- Carefully managing annual rate structure increases so that members can plan ahead
- Creating a better communication system to notify customers of water outages and other problems
- Developing a separate "user-friendly" Water System website with member training opportunities
- Getting back to hybrid style Water Committee meetings to facilitate better interaction for committee members and HOA members
- Remembering to say thank you to our customers for their support and patience when things don't go as well as we would all like.

RESPECTFULLY SERVING OUR LLCC COMMUNITY,